

32(V)

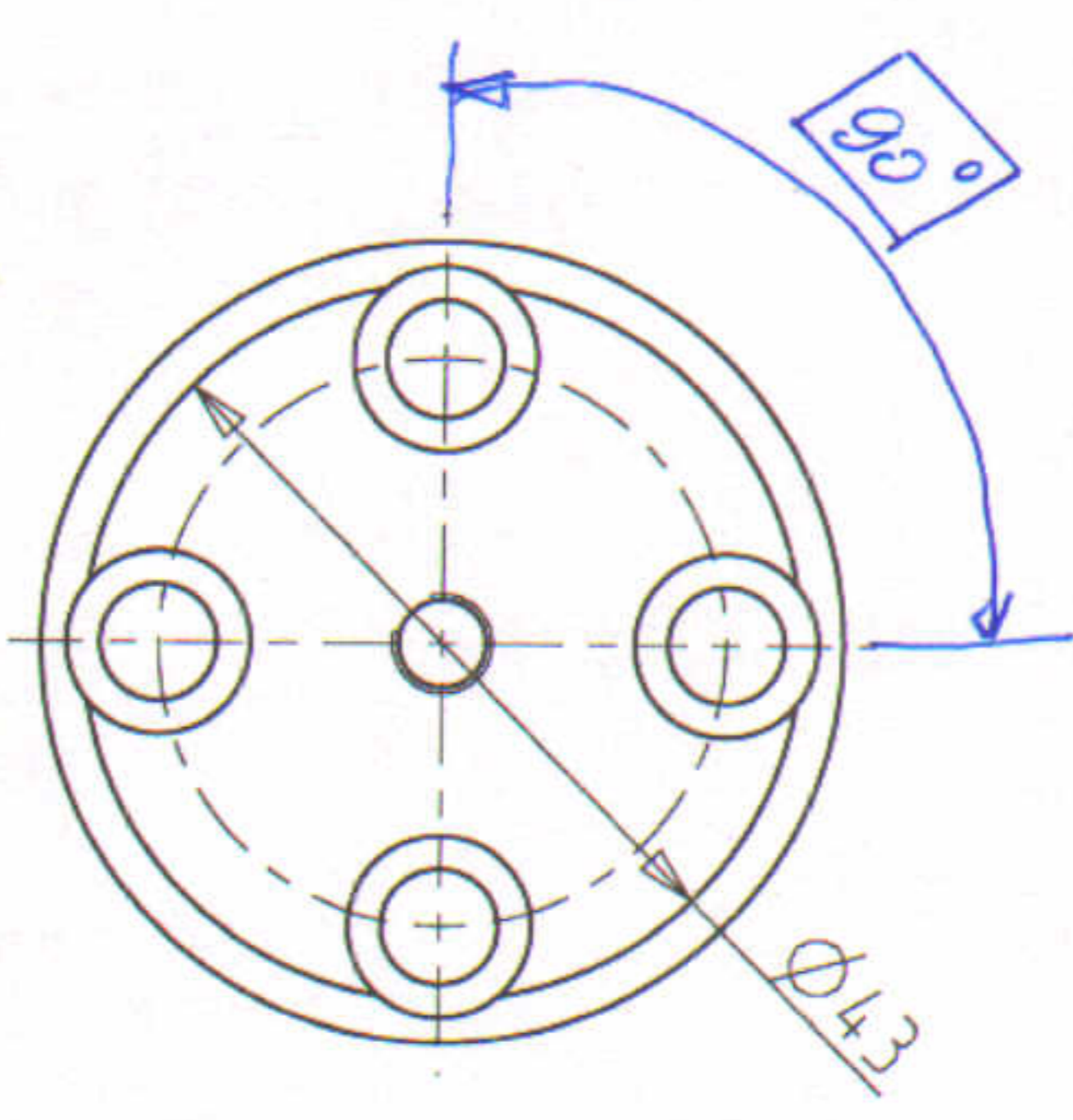
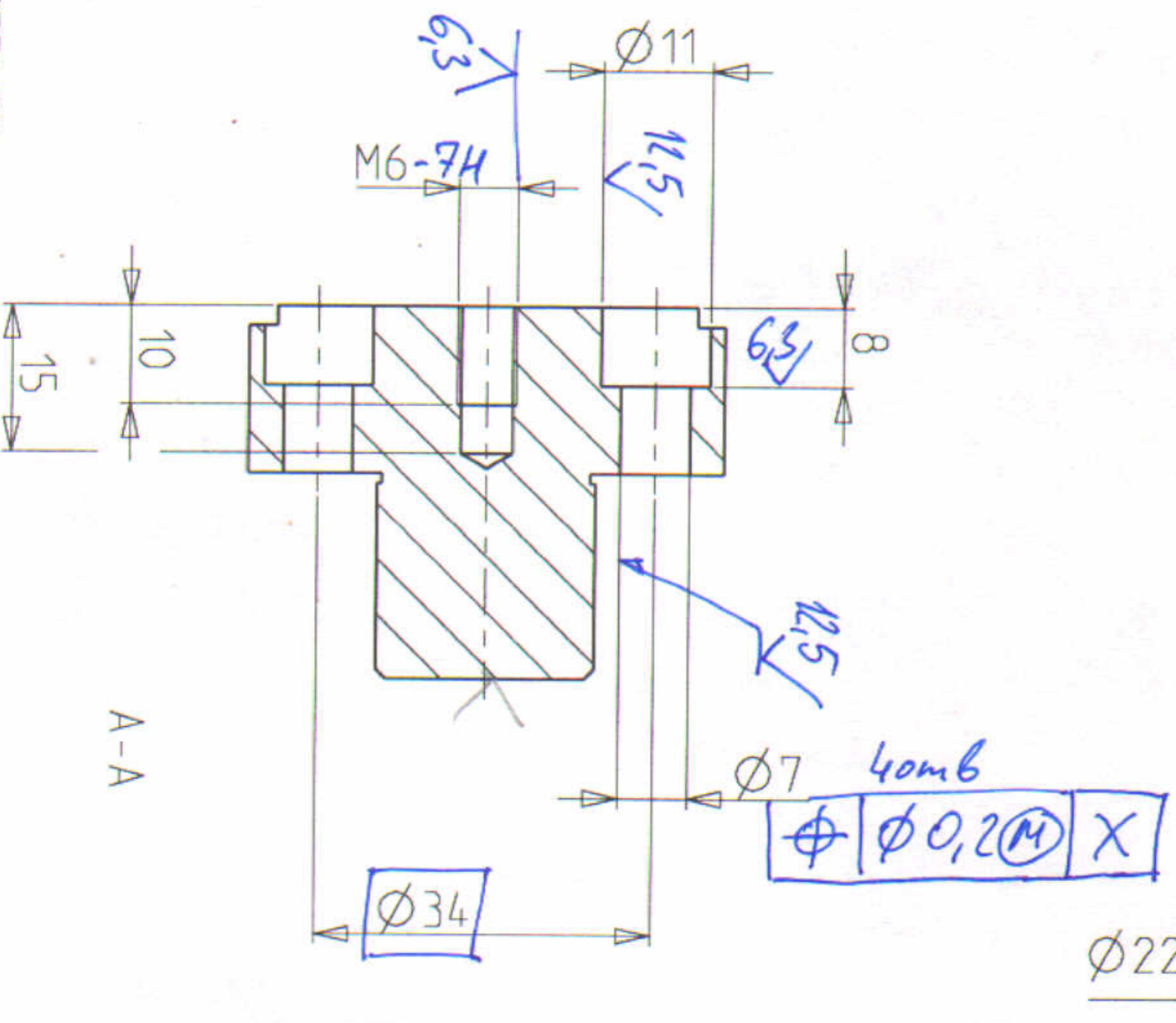
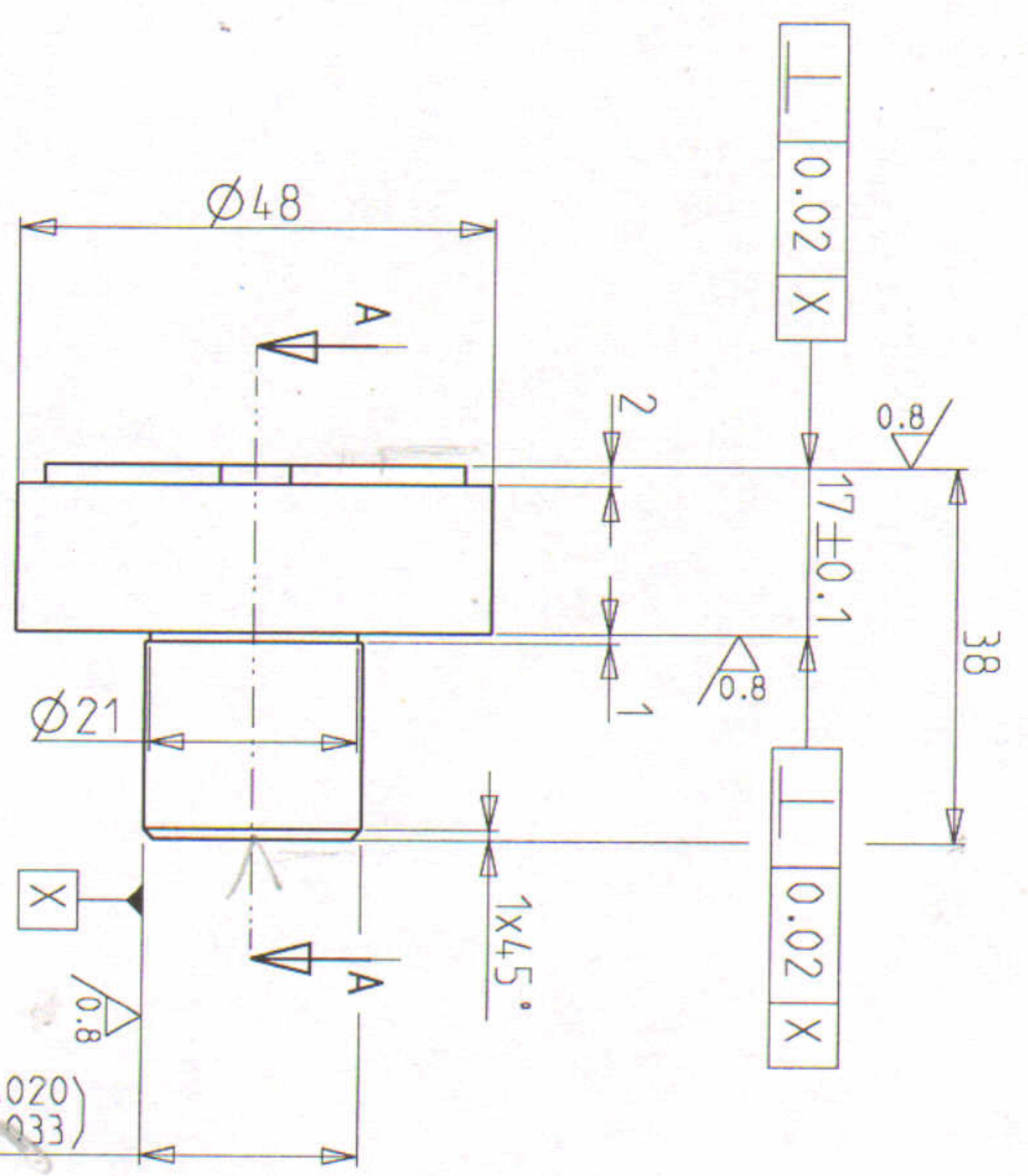

Закрз №114 СК6П1300.072.401 Опора

НЕУСТАНОВЛЕННЫЕ ФАСКИ 0,5X45°
Smussi non quotati 0.5x45°

РАЗРЯД НАУГЛЕРОЖИВАНИЯ: CM 7
ГЛУБИНА : 0,6 : 0,8
ЖЕСТКОСТЬ: 58 : 60

ПРИМЕЧАНИЕ : ПРЕДОХРАНИТЬ РЕЗЬБУ ОТ ТЕРМООБРАБОТКИ
N.B.: Proteggere il filetto dai trattamenti termici
Classe di Cmt : CM 7
Profondità : 0.6 ± 0.8
Durezza : 58 ± 60 HRC

Сталь 20XH
ГОСТ4543-71

PROPRIETARY AND RESERVED
СОБСТВЕННОСТЬ ПРОИЗВОДИТЕЛЯ

Ø 55x45

ОПОРА ПРИНАДЛЕЖНОСТИ
102, 302, 15706, 302, 105, 302, 105

REV. DATA		FIRMA		OGGETTO DELLA MODIFICA / SUBJECT OF MODIFICATION	
SUL GREZZO ROUGH COMP.		IN LAVORO MACH. COMP.		TRATT. TERMICO HEAT TREATMENT	
CARATT. MECCAN. MECHANICAL SPECS.		TOLLERANZE GENERALI LAVORAZ. GENERAL MACHINING TOLERANCES		SEGNII DI LAVORAZ / MACHINING MARKS GENERAL ALTRE LAVORAZIONI OTHER MACHINING	
HRC: -		TOLL. GREZZO/ROUGH ±0.20		SCALA / SCALE	
HB: -		TOLL. PARTI FUSE/TOL. OF CAST PIECES ±0.30		1:1	
R: -		SPESSORI / THICKNESSES < 10mm ± 1mm		DISEGNATO / DRAWN BY M. ANGELI	
N/mm ²		0.3		APPROVATO / APPR. BY N. VALSECCHI	
PESO Kg		TOLLERANZE GENERALI LAVORAZ. GENERAL MACHINING TOLERANCES		DATA/DATE 27.10.11	
WEIGHT Kg		100 > 100 < 300 > 300 < 1000		FORI/HOLES	
GREZZO/ROUGH		±0.20 ±0.30 ±0.40		HI/2	
TOLL. PARTI FUSE/TOL. OF CAST PIECES SPESSORI / THICKNESSES		± 10x		DI SEGNO N. / DRAWING NO. F04020074	
N/mm ²		< 10mm ± 1mm		REV. - -	
APPROGGIO ACCESSORIO		DETAIL		F04010220	
F04020074		F04010220		F04010220	
F04010220		F04010220		F04010220	
F04010220		F04010220		F04010220	